

DAVID Y. IGE
GOVERNOR



STATE OF HAWAII
DEPARTMENT OF TRANSPORTATION
869 PUNCHBOWL STREET
HONOLULU, HAWAII 96813-5097

JADE T. BUTAY
DIRECTOR

Deputy Directors
ROSS M. HIGASHI
EDUARDO P. MANGLALLAN
EDWIN H. SNIFFEN

IN REPLY REFER TO:

Board of Land and
Natural Resources
State of Hawai'i
Honolulu, Hawai'i

ISSUANCE OF A REVOCABLE PERMIT FOR COMMERCIAL USE OF A
T-HANGAR FOR STORAGE AND MAINTENANCE OF AIRCRAFT IN SUPPORT
OF AN AERONAUTICAL FLIGHT SCHOOL BUSINESS
BARBERS POINT FLIGHT SCHOOL, LLC
KALAELOA AIRPORT
TAX MAP KEY: (1) 9-1-013: 116

O'AHU

REQUEST:

Issuance of a revocable permit for commercial use of a T-Hangar for storage and maintenance of aircraft in support of an aeronautical flight school business to Barbers Point Flight School, LLC, situated at Kalaeloa Airport.

LEGAL REFERENCE:

Section 171-55, Hawai'i Revised Statutes (HRS).

APPLICANT:

Barbers Point Flight School, LLC, whose mailing address is 91-1259 Midway Road, Bldg. 104, Suite 2, Kapolei, Hawai'i 96707.

LOCATION AND TAX MAP KEY:

A portion of Kalaeloa Airport, Kapolei, Island of Oahu, State of Hawai'i, identified by Tax Map Key: 1st Division, 9-1-013: 116.

AREA:

Large Plane Hangar Unit No. 409-104, containing an area of approximately 1,763 square feet, as shown and delineated on the attached map labeled Exhibit "A".

ITEM M-6

BLNR – ISSUANCE OF A REVOCABLE PERMIT FOR COMMERCIAL USE OF A T-HANGAR FOR STORAGE AND MAINTENANCE OF AIRCRAFT IN SUPPORT OF AN AERONAUTICAL FLIGHT SCHOOL BUSINESS, BARBERS POINT FLIGHT SCHOOL, LLC

Page 2

ZONING:

State Land Use District: Urban
City and County of Honolulu LUO: Industrial (I-2)

LAND TITLE STATUS:

Non-Ceded - Section 5(a) lands of the Hawai‘i Admission Act
DHHL 30% entitlement lands pursuant to Hawai‘i Admission Act YES ___ NO X

CURRENT USE STATUS:

Land presently encumbered by Governor’s Executive Order No. 3861, setting aside Kalaeloa Airport under the control and management of the State of Hawai‘i, Department of Transportation, Airports Division (DOTA) for Airport Purposes.

CHARACTER OF USE:

T-Hangar for storage and maintenance of aircraft used in support of a commercial aeronautical flight school business (1976 Cessna 310R, Tail No. N-222PE).

COMMENCEMENT DATE:

To be determined by the Director of Transportation at a later date.

MONTHLY RENTAL:

\$1,939.30 (as determined from the DOTA schedule of rates and charges, commercial rate for T-hangar, established by appraisal of Airports property statewide).

SECURITY DEPOSIT:

\$5,817.90, or three (3) times the monthly rental in effect.

DCCA VERIFICATION:

Place of business registration confirmed: YES X NO _____
Registered business name confirmed: YES X NO _____
Good standing confirmed: YES X NO _____

BLNR – ISSUANCE OF A REVOCABLE PERMIT FOR COMMERCIAL USE OF A
T-HANGAR FOR STORAGE AND MAINTENANCE OF AIRCRAFT IN SUPPORT
OF AN AERONAUTICAL FLIGHT SCHOOL BUSINESS,
BARBERS POINT FLIGHT SCHOOL, LLC
Page 3

CHAPTER 343, HRS - ENVIRONMENTAL ASSESSMENT:

The subject land area is covered by the Final Environmental Assessment for the Kalaeloa Airfield Development Plan Improvements, State Project No. AO5011-02 dated June 2010. This Environmental Assessment was prepared by Wilson Okamoto Corp. for the State of Hawai'i, Department of Transportation, Airports Division, in part to evaluate the environmental effects of the recommended Kalaeloa Airfield Master Plan to meet existing and forecast general aviation demands.

REMARKS:

In accordance with Section 171-55 HRS, relating to Permits, the Department of Transportation proposes to issue a revocable permit for commercial use of a T-Hangar for storage and maintenance of aircraft in support of an aeronautical flight school business to Barbers Point Flight School, LLC., situated at Kalaeloa Airport.

RECOMMENDATION:

That the Board authorize the Department of Transportation to issue a month-to-month revocable permit to Barbers Point Flight School, LLC, subject to: (1) terms and conditions herein outlined, which are by reference incorporated herein; and (2) such additional terms and conditions as may be prescribed by the Director of Transportation to best serve the interests of the State.

Respectfully submitted,

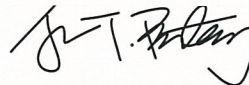

JADE T. BUTAY
Director of Transportation

APPROVED FOR SUBMITTAL:

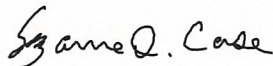

SUZANNE D. CASE
Chairperson and Member

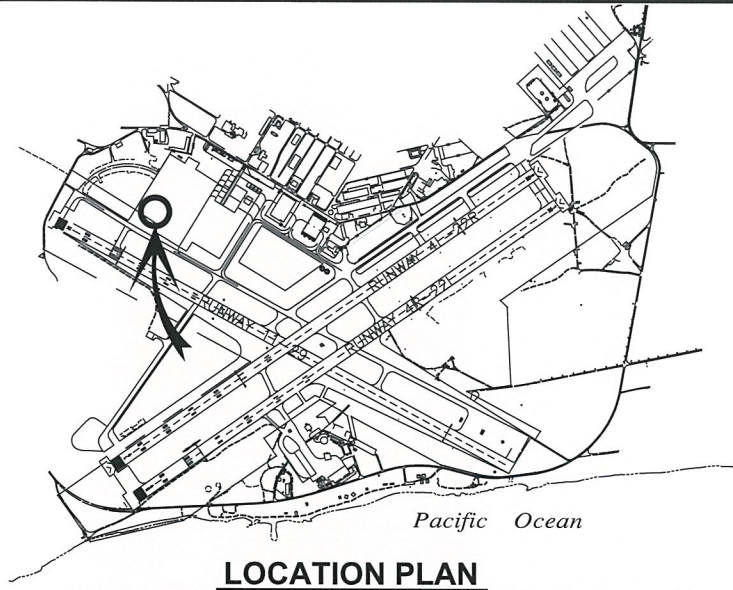

3000:1

LOCATION PLAN

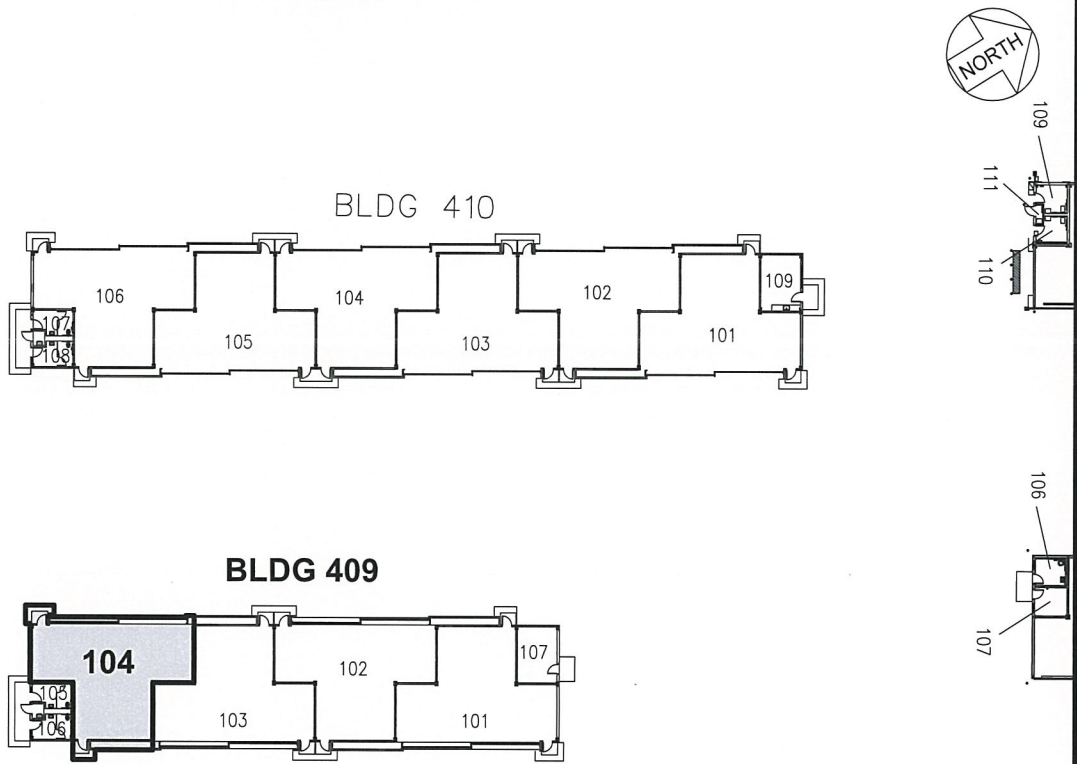

SCALE: 1" = 60'

BLDG/ROOM	SQ. FT.
409 104	1,763

RP-9231

DATE : MARCH 2022

EXHIBIT: **A**

BARBERS POINT FLIGHT SCHOOL LLC

T-HANGAR

**409104
PLAT D1**