

DAVID Y. IGE
GOVERNOR



STATE OF HAWAII
DEPARTMENT OF TRANSPORTATION
869 PUNCHBOWL STREET
HONOLULU, HAWAII 96813-5097

JADE T. BUTAY
DIRECTOR

Deputy Directors
ROSS M. HIGASHI
EDUARDO P. MANGLALLAN
EDWIN H. SNIFFEN

IN REPLY REFER TO:

Board of Land and
Natural Resources
State of Hawai'i
Honolulu, Hawai'i

ISSUANCE OF A REVOCABLE PERMIT FOR EQUIPMENT PARKING
SOUTHWEST AIRLINES CO.
HILO INTERNATIONAL AIRPORT
TAX MAP KEY: (3) 2-1-12: PORTION OF 09

HAWAI'I

LEGAL REFERENCE:

Section 171-55, Hawai'i Revised Statutes (HRS).

APPLICANT:

Southwest Airlines Co. (SAC), whose business address is 2702 Love Field Drive, Dallas, Texas 75235.

LOCATION AND TAX MAP KEY:

Portions of Hilo International Airport (ITO), Hilo, Island of Hawai'i, identified by Tax Map Key: 3rd Division, 2-1-12: Portions of 09.

AREAS:

Building/Room No. 306-137A, containing an area of approximately 900 square feet, and Building/Room No. 306-137B, containing an area of approximately 900 square feet, as shown and delineated on the attached map labeled Exhibit "A".

ZONING:

State Land Use District: Urban
County of Hawai'i: Industrial (ML-20)

ITEM M-7

BLNR – ISSUANCE OF A REVOCABLE PERMIT FOR EQUIPMENT PARKING
SOUTHWEST AIRLINES CO.

Page 2

LAND TITLE STATUS:

Section 5(a) lands of the Hawai'i Admission Act: Ceded
DHHL 30% entitlement lands pursuant to the Hawai'i Admission Act: YES __ NO X

CURRENT USE STATUS:

Land presently encumbered by Governor's Executive Order No. 2653, dated March 5, 1973, setting aside 284.466 acres designated as General Lyman Field under the control and management of the State of Hawai'i, Department of Transportation, Airports Division for public purposes.

CHARACTER OF USE:

SAC will use the spaces for equipment parking, as part of its Signatory Airline Carrier Operations at ITO.

COMMENCEMENT DATE:

Upon complete execution of the revocable permit.

MONTHLY RENTAL:

\$6,363.00 (based on a rate of \$42.42 per square foot, per annum, as determined from the Airports Division Signatory Rates and Charges, Hawai'i Airports System, effective July 1, 2021).

SECURITY DEPOSIT:

\$19,089.00, or three (3) times the monthly rental in effect.

DCCA VERIFICATION:

Place of business registration confirmed:	YES <u>X</u>	NO _____
Registered business name confirmed:	YES <u>X</u>	NO _____
Good standing confirmed:	YES <u>X</u>	NO _____

CHAPTER 343, HRS - ENVIRONMENTAL ASSESSMENT:

The State of Hawaii, Department of Transportation, Airports Division (DOTA), has determined that the subject land use is covered by the Final Environmental Impact Statement (EIS), New Passenger Terminal, General Lyman Field, Hilo, Hawaii, published by the Office of Environmental Quality Control (OEQC) in the October 17, 1973, issue of The EIS Newsletter. Accordingly, all relevant mitigation from the EIS and best

BLNR – ISSUANCE OF A REVOCABLE PERMIT FOR EQUIPMENT PARKING
SOUTHWEST AIRLINES CO.

Page 3

management practices will be implemented to address the minimum impacts of this action. On July 1, 1989, General Lyman Field was renamed Hilo International Airport.

REMARKS:

In accordance with Section 171-55, HRS, relating to Permits, the Department of Transportation proposes to issue a month-to-month revocable permit to SAC for equipment parking, as part of its Signatory Airline Carrier Operation at ITO.

RECOMMENDATION:

That the Board authorize the Department of Transportation to issue a month-to-month revocable permit to SAC, subject to: (1) terms and conditions herein outlined, which are by reference incorporated herein; and (2) such additional terms and conditions as may be prescribed by the Director of Transportation to best serve the interests of the State.

Respectfully submitted,

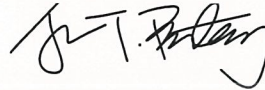

JADE T. BUTAY
Director of Transportation

APPROVED FOR SUBMITTAL:

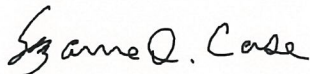

SUZANNE D. CASE
Chairperson and Member

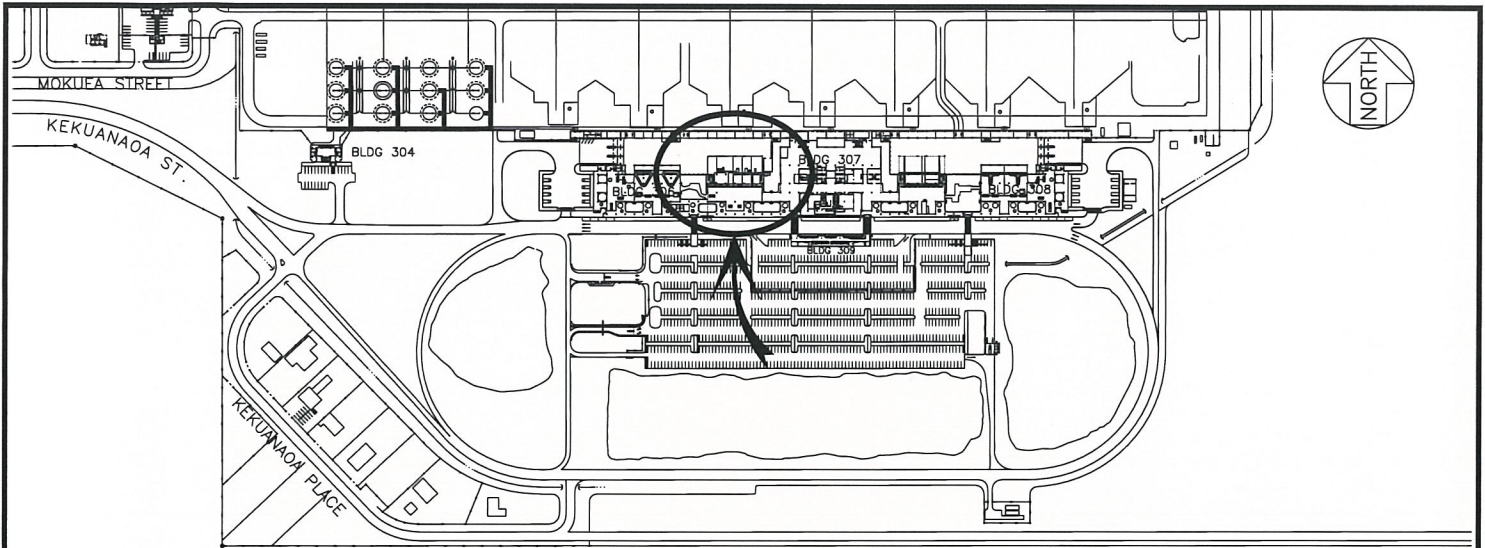

LOCATION PLAN

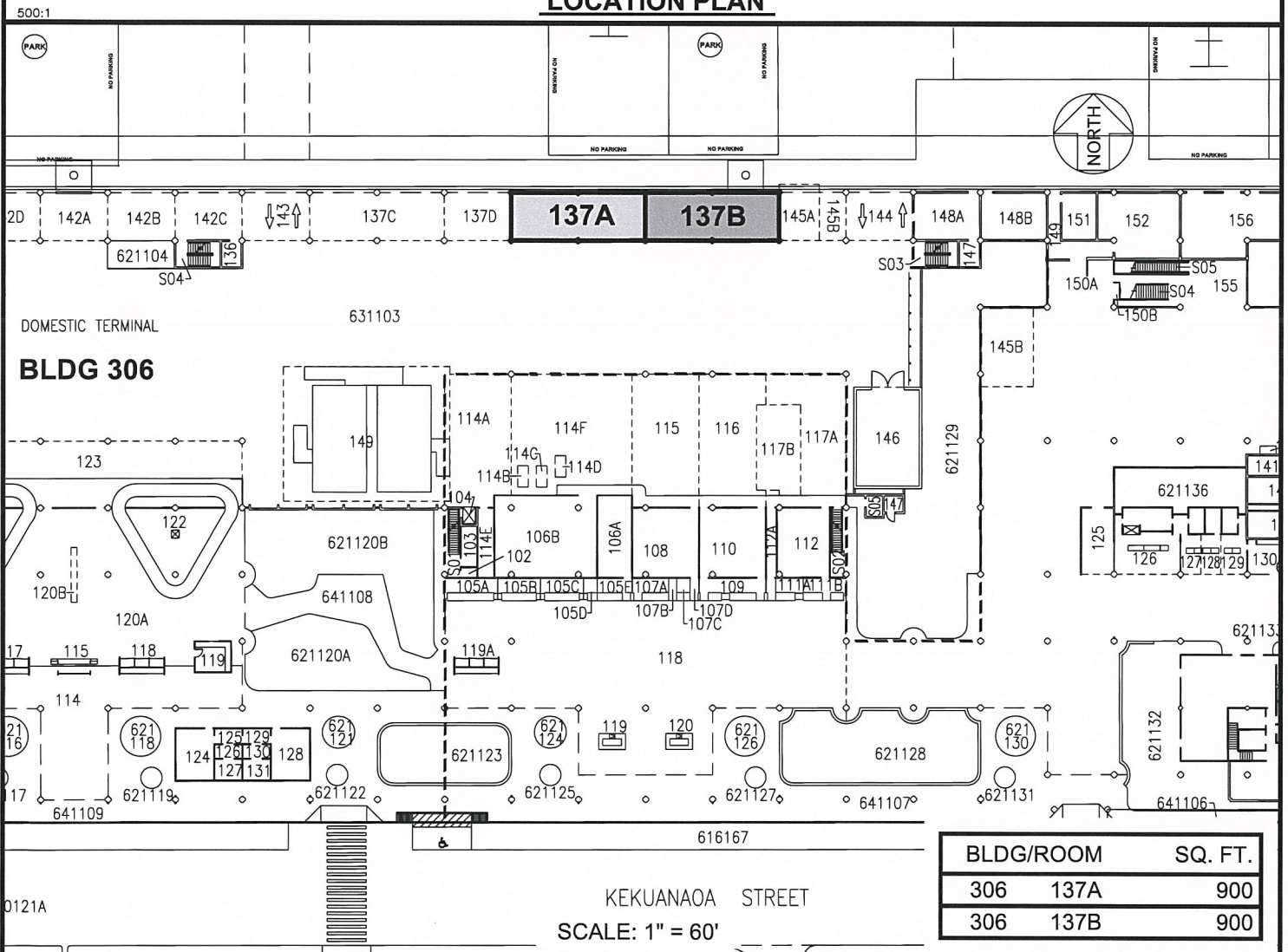

BLDG/ROOM	SQ. FT.
306 137A	900
306 137B	900

KEKUAOAO STREET
SCALE: 1" = 60'

RP-9241

DATE : JUNE 2022

EXHIBIT: **A**

DEPARTMENT OF TRANSPORTATION
STATE OF HAWAII
Airports Division

SOUTHWEST AIRLINES CO.

**BUILDING 306
DOMESTIC TERMINAL
GROUND LEVEL**

**306137A-B
PLAT C1,42**